

Door width: Maximum 60"

Door length: Maximum 120" unclassified

- 1 LSL type 3 3/8" (86 mm) cross member
- 2 leaves of 4 1/4" (108 mm) of LSL type including 7/8" (22 mm) of hardwood matching the face
- 3 Embossed honeycomb cores (recycled)
- 4 Integrated reinforcement
- 5. Faced with the choice between rigid panels or wood veneer (see descriptive sheet)

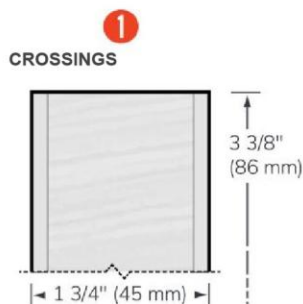
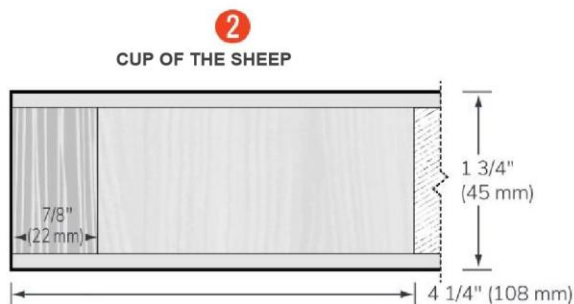

Note that all dimensions are raw.

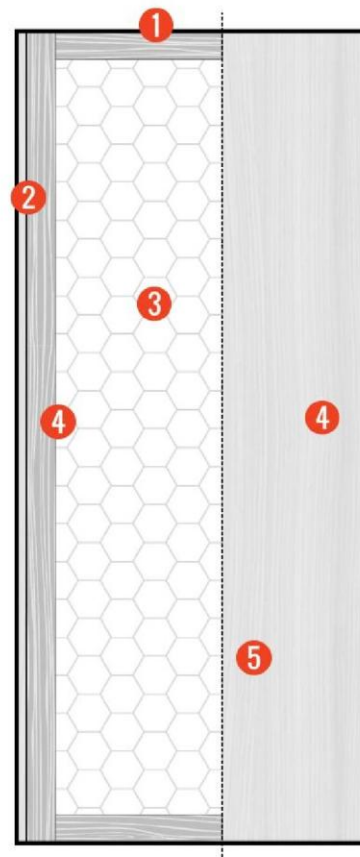

Type 1 adhesive, waterproof
Urea-free, formaldehyde-free

Fire resistance
Not offered

3-year warranty

Eligible credits

To obtain the credits, specify "PUSM Eco Series"

LEED Canada - NC 2009

M.R.						Q.E.I		I.D.		P.R.
3	4	5	7	5.1	5.2	3.2 op2	4.1	4.4	1.mo1	2
✓	✓	✓	✓			✓	✓	✓	✓	✓

LEED Canada - C1 (v1.0)

M.R.							Q.E.I		I.D.	
3.1	3.2	4.1	4.2	5.1	5.2	7	3.2 opB	4.1	4.4	1.1 1.2
✓	✓	✓	✓	✓	✓	✓	✓	✓	✓	✓